

**EXISTING PLAN OF SINGLE STOREY
BUILDING OF GOVT. MODEL SANSKRITI
SR. SEC. SCHOOL (1801)
VILL.- PADHA, DISST. KARNAL**

NOTE: TOTAL PLOT AREA OF SCHOOL
82282 Sq. FT., 9142.4 Sq. Yd., 744.24 Sq. MT, 1.9 ACRE
TOTAL COVER AREA
20224 Sq. FT., 2247 Sq. Yd., 1879 Sq. MT.
HEIGHT OF BUILDING
3.65 MT., 12'-0" Feet

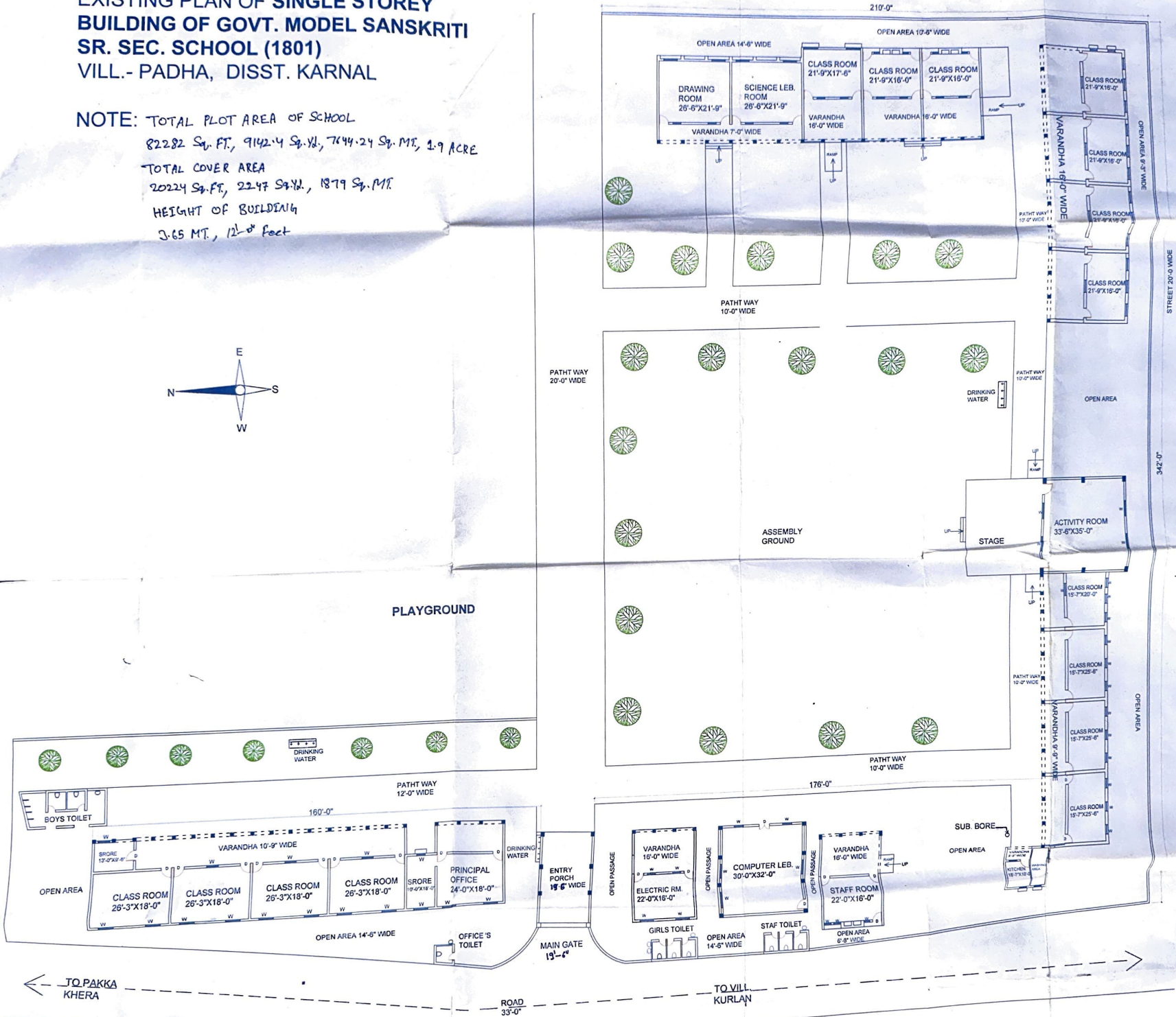
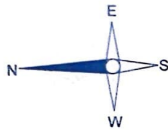

ROAD
33'-0"

TO VILL.
KURLAN

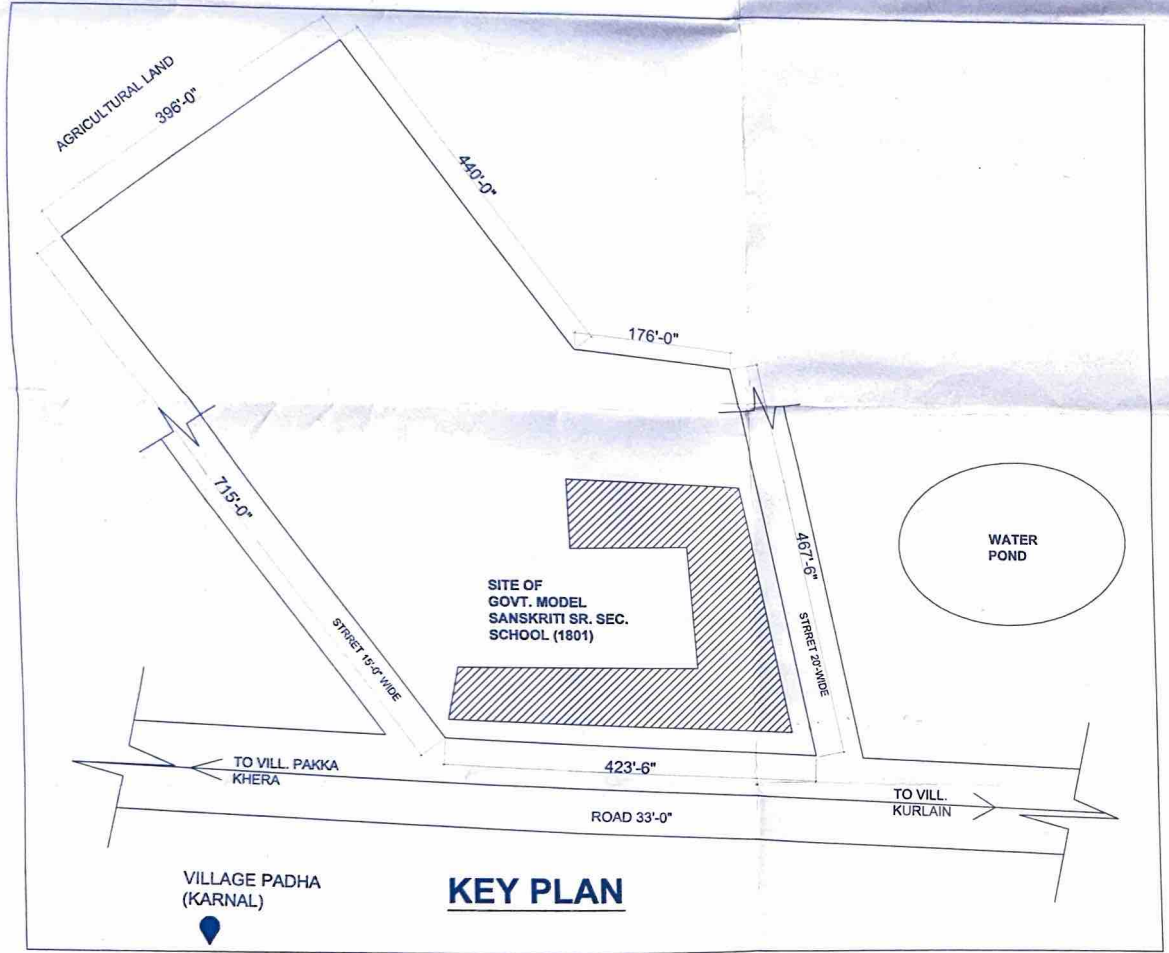

KEY PLAN

VILLAGE PADHA
(KARNAL)

HEAD/ PRINCIPAL

AREA CHART :-

	AREA	SIZE
1	TOTAL AREA	364049 sq ft. or 33821 sq. mt. or 40450 sq. yd or 1348 Marla or 67.3 kanal
2	TOTAL COVER AREA	20224 sq ft. or 1879 sq. mt. or 2247 sq. yd
2	TOTAL OPEN AREA	318307 sq ft. or 29571 sq. mt. or 35367 sq. yd 1178 Marla
2	PRIMARY SCHOOL AREA	25518 sq ft. or 2370 sq. mt. or 2835 sq. yd
4	TOTAL NO. OF ROOMS	25
5	TOTAL NO. OF TOILETS	9

ROOMS SIZE DIScription :-

S.N	NOS	ROOMS TYPE	SIZE
1	1	PRINCIPAL OFFICE	24'-0"X18'-0"
2	4	CLASS ROOMS	26'-3"X18'-0"
3	1	CLASS ROOM	21'-9"X17'-6"
4	8	CLASS ROOM	21'-9"X16'-0"
5	1	CLASS ROOM	15'-7"X20'-0"
6	3	CLASS ROOM	15'-7"X25'-6"
7	1	ACTIVITY ROOM	33'-6"X35'-0"
8	1	DRAWING ROOM	26'-8"X21'-0"
9	1	SCIENCE LAB	25'-6"X21'-9"
10	1	STAFF ROOM	22'-0"X16'-0"
11	1	COMPUTER LAB	30'-0"X32'-0"
12	1	ELECTRIC ROOM	22'-0"X16'-0"
13	1	KITCHEN ROOM	15'-7"X10'-0"
14	1	STORE ROOM	10'-0"X18'-0"
15	1	STORE ROOM	13'-0"X9'-6"
16	1	ENT. GATE PORCH	18'-0"X35'-0"
17	1	OFFICE TOILET	6'-3"X5'-0"
18	3	STAFF TOILET	6'-3"X15'-0"
19	3	GIRLS TOILET	6'-3"X12'-0"
20	2	BOYS TOILET	9'-0"X15'-0"

(Signature)
District Education Officer
KARNAL

(Signature)
Sajeev Kumar
J.E. S.S.A. Indri
PRINCIPAL
Govt. Sr. Sec. School
PADHA, (Karnal)

Ar. Devender Sharma
Architect, A.I.I.A. MCA
A.I.I.A. NO. 17621, CA/2011/52316
Shop No. 26, HUDA Sector-6, Panipat